

HESELSTORGET 14, NACKA

Plan 4

ca. 445 kvm

44 Arbetsplatser

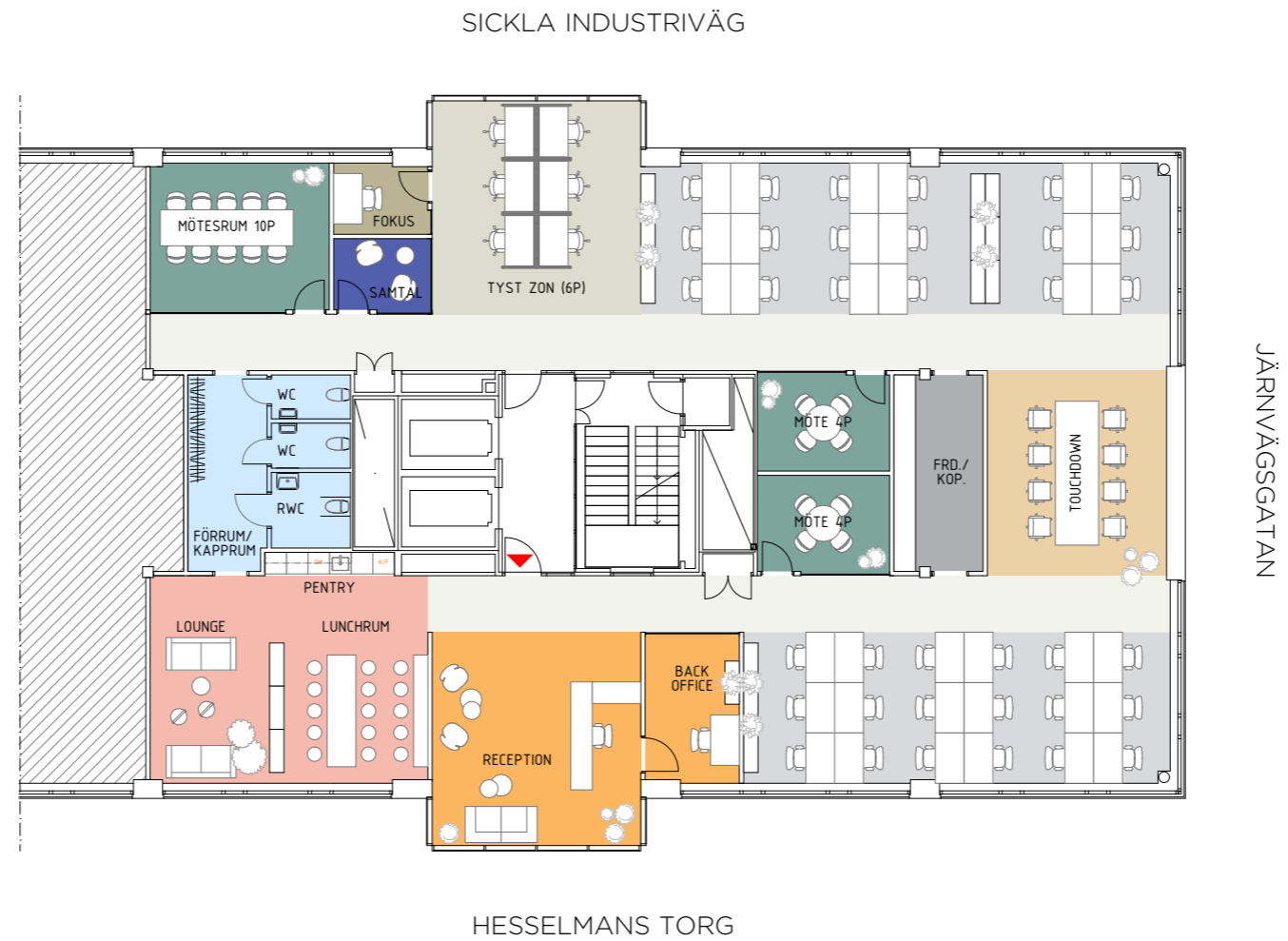

- | | | | |
|-----------------|-----------------------|----------------------|------------------------------|
| INTERN YTA | RELAX/AKTIVITETSNUM | TELEFON/SAMTALSNUM | ARBETSPLATSER 1400X800 |
| ÖPPET KONTOR | TOUCHDOWN/WORK LOUNGE | FÖRRÅD/KOPIERINGSNUM | TYSTA ARBETSPLATSER 1400X800 |
| TYSTRUM | RECEPTION/EXTERN YTA | TEKNIK | |
| FOKUSNUM | MÖTESNUM | WC | |
| PENTRY/LUNCHNUM | SAMTALSNUM (2-4P) | ENTRÉPIL | |

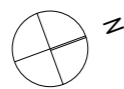
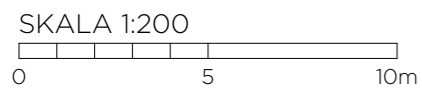

HESELSTORGET TORG

Skala 1:200 (A3)

2020-07-03

Studio Stockholm
Arkitektur

